

Technical data

A4VG serie 35

Size		NG		56	71	90	
Geometric displacement, per revolution							
	Variable pump	$V_{g \max}$	cm ³	56	71	90	
	Boost pump (at $p = 20$ bar)	$V_{g Sp}$	cm ³	13.8	18.9	18.9	
Rotational speed ¹⁾	Maximum at $V_{g \max}$	$n_{nom 5}$	rpm	3600	3300 ²⁾	3050	
	At $\Delta p \geq 40$ bar ($t < 15$ s)	$n_{max 40}$	rpm	4050	On request	3500	
	Minimum	n_{min}	rpm	500	500	500	
Flow	At n_{nom} and $V_{g \max}$	q_v	l/min	202	234	284	
Power ³⁾	At n_{nom} , $V_{g \max}$ and $\Delta p = 400$ bar	P	kW	134	156	189	
Torque ³⁾	With $V_{g \max}$ and	$\Delta p = 400$ bar	M	Nm	357	452	573
		$\Delta p = 100$ bar	M	Nm	89	113	143
Rotary stiffness of drive shaft	S7	c	kNm/rad	80.8	98.8	107.6	
	V8	c	kNm/rad	95	120.9	–	
	T1	c	kNm/rad	–	–	158.1	
	Z8	c	kNm/rad	95.8	122.8	137	
Moment of inertia of the rotary group		J_{TW}	kgm ²	0.0066	0.0097	0.0149	
Maximum angular acceleration ⁴⁾		α	rad/s ²	24000	21000	18000	
Case volume		V	l	1.6	2.1	2.0	
Weight (without through drive) approx. ⁵⁾		m	kg	37	48	49	



Схема установки

Dimensions, size 56

● Center of gravity

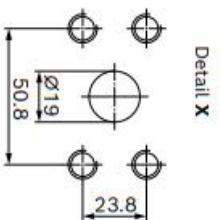
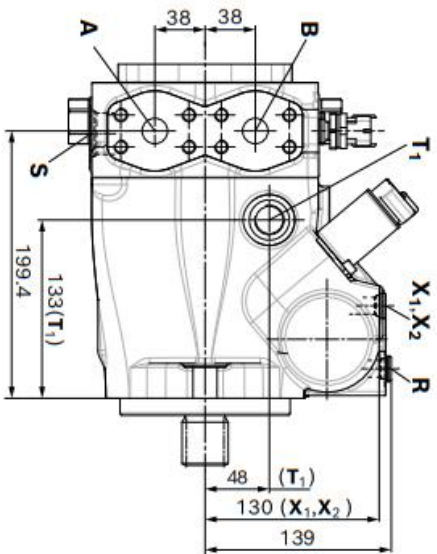
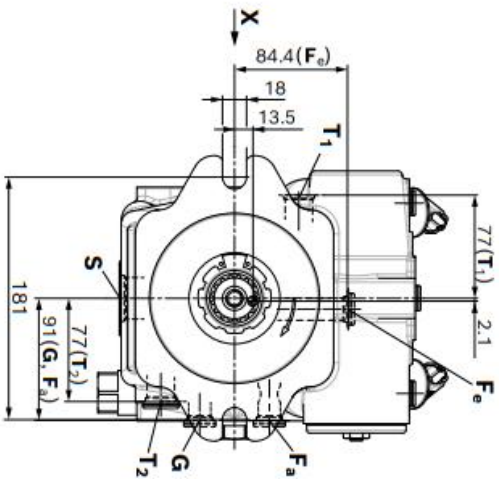
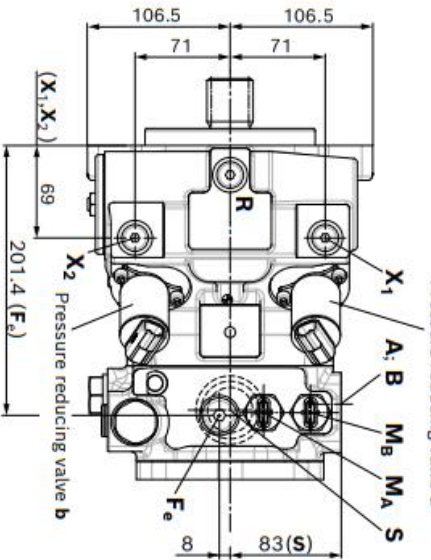
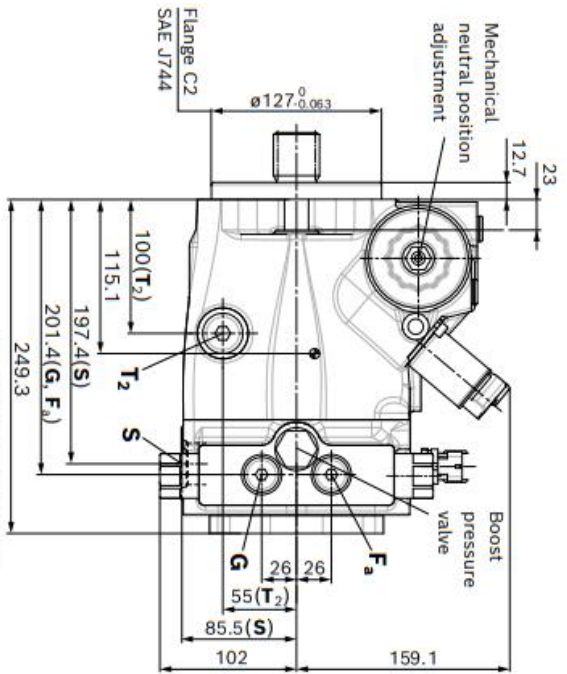
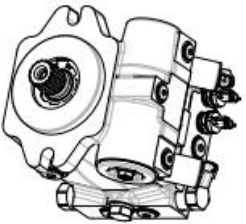

Dimensions, size 71

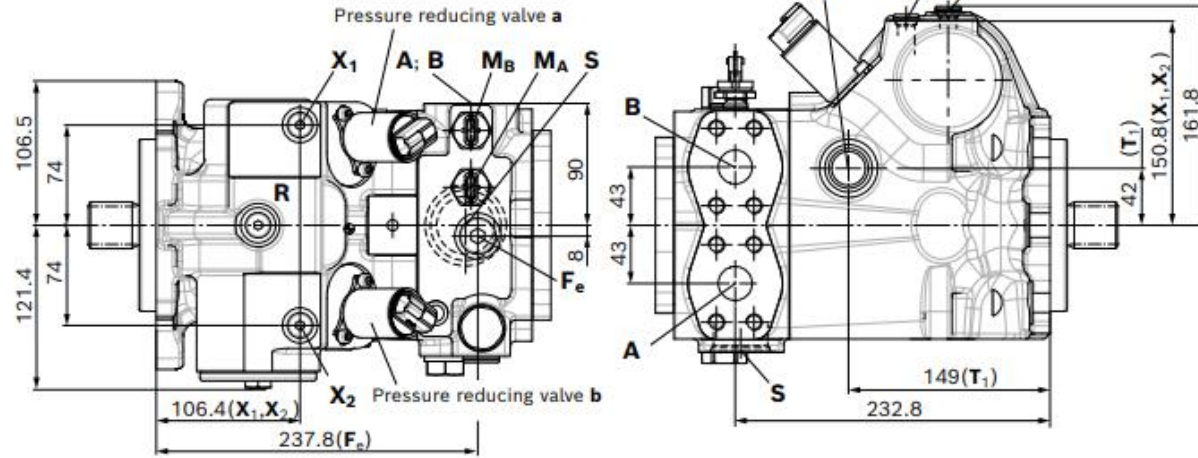
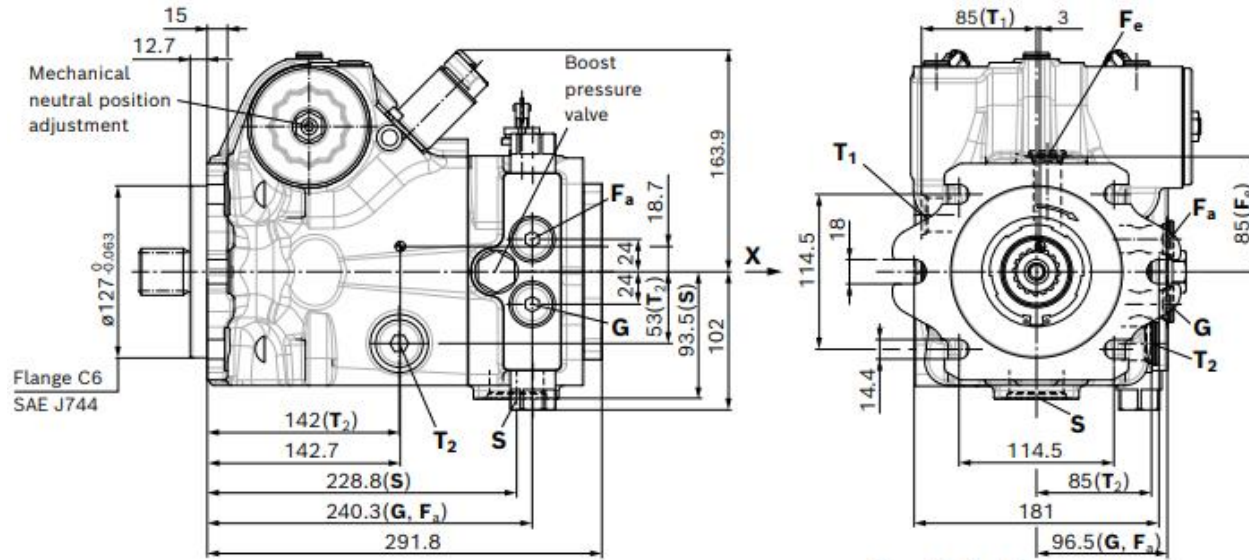

● Center of gravity

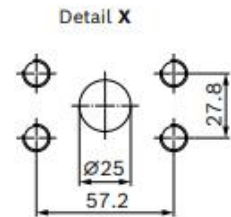

Dimensions, size 90

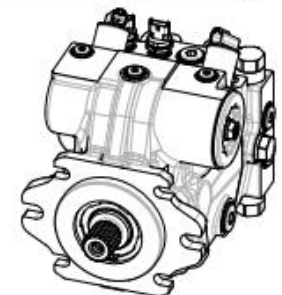
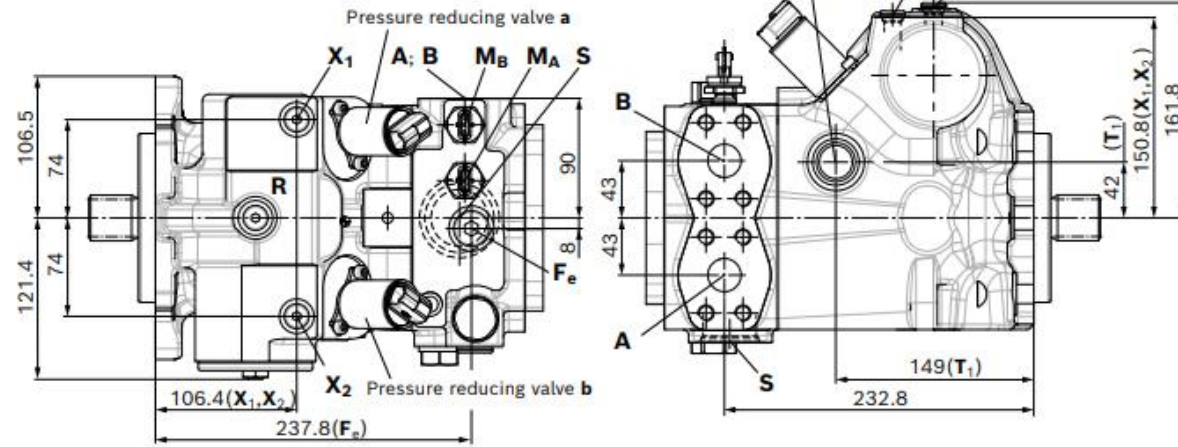
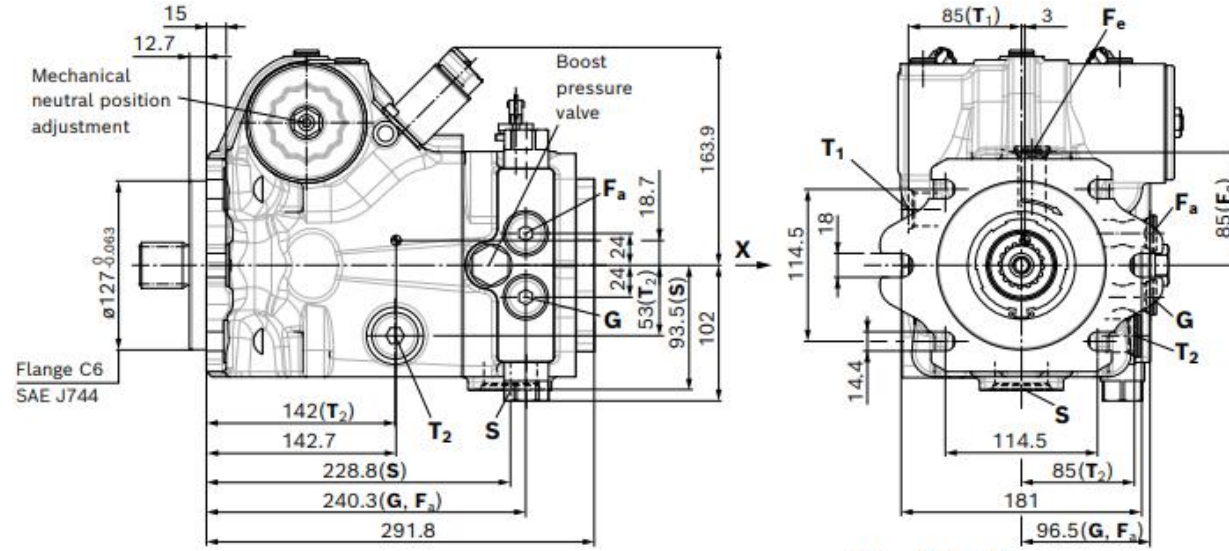

● Center of gravity

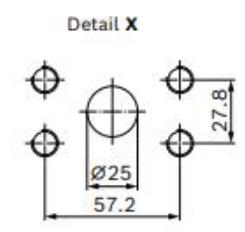

Примечания: Если Вам нужна более подробная информация, можете связаться с нами (например, структура и параметры размера отверстия для утечки масла (Dt); структура входа и выхода и параметры размера шестеренного насоса; требования к форме и параметрам и нтерфейса гнезда электромагнитного клапана, уровень защиты и т.д.)